

Ansicht "Z"
View "Z"

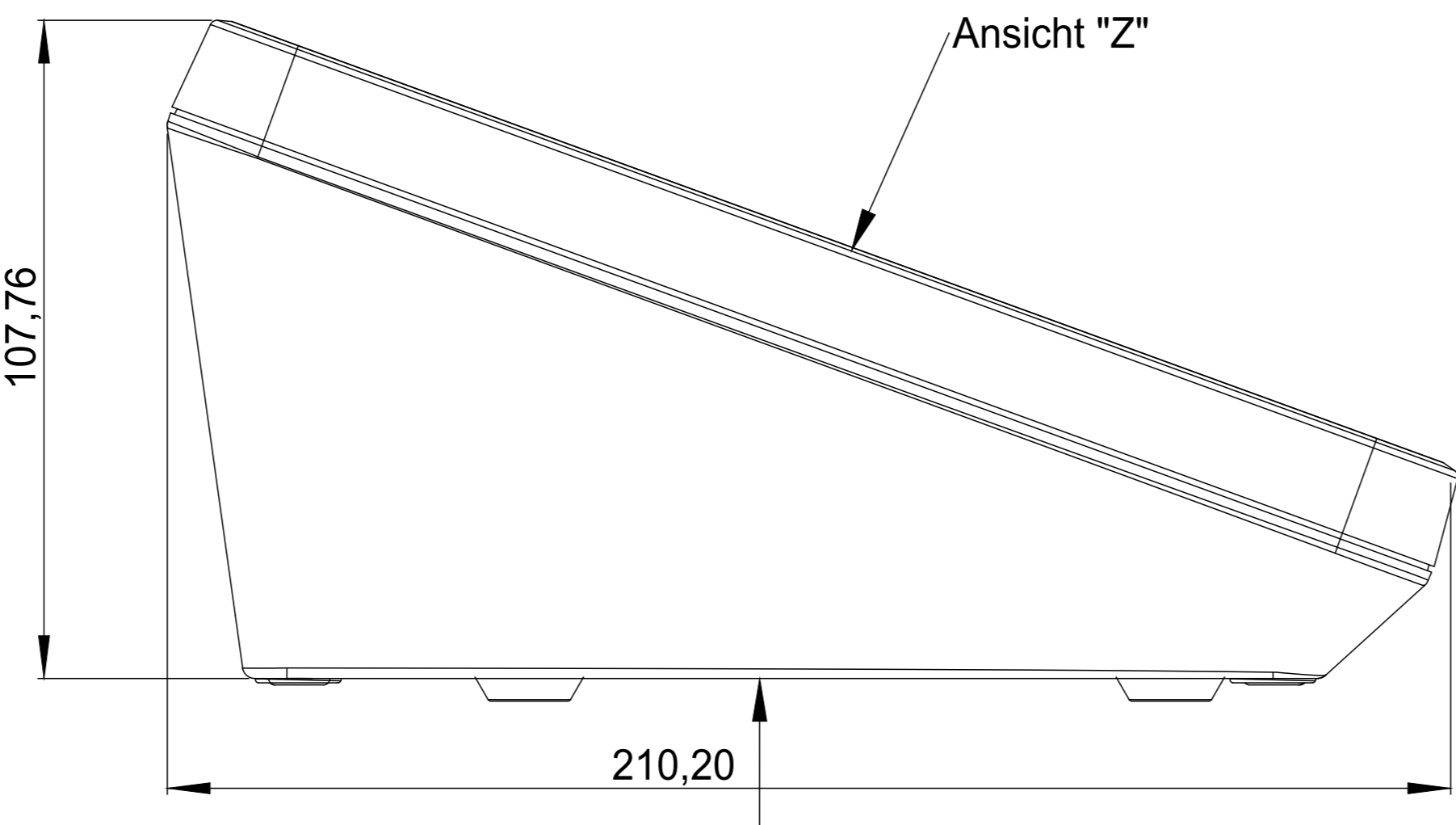

Ansicht "Y"
View "Y"

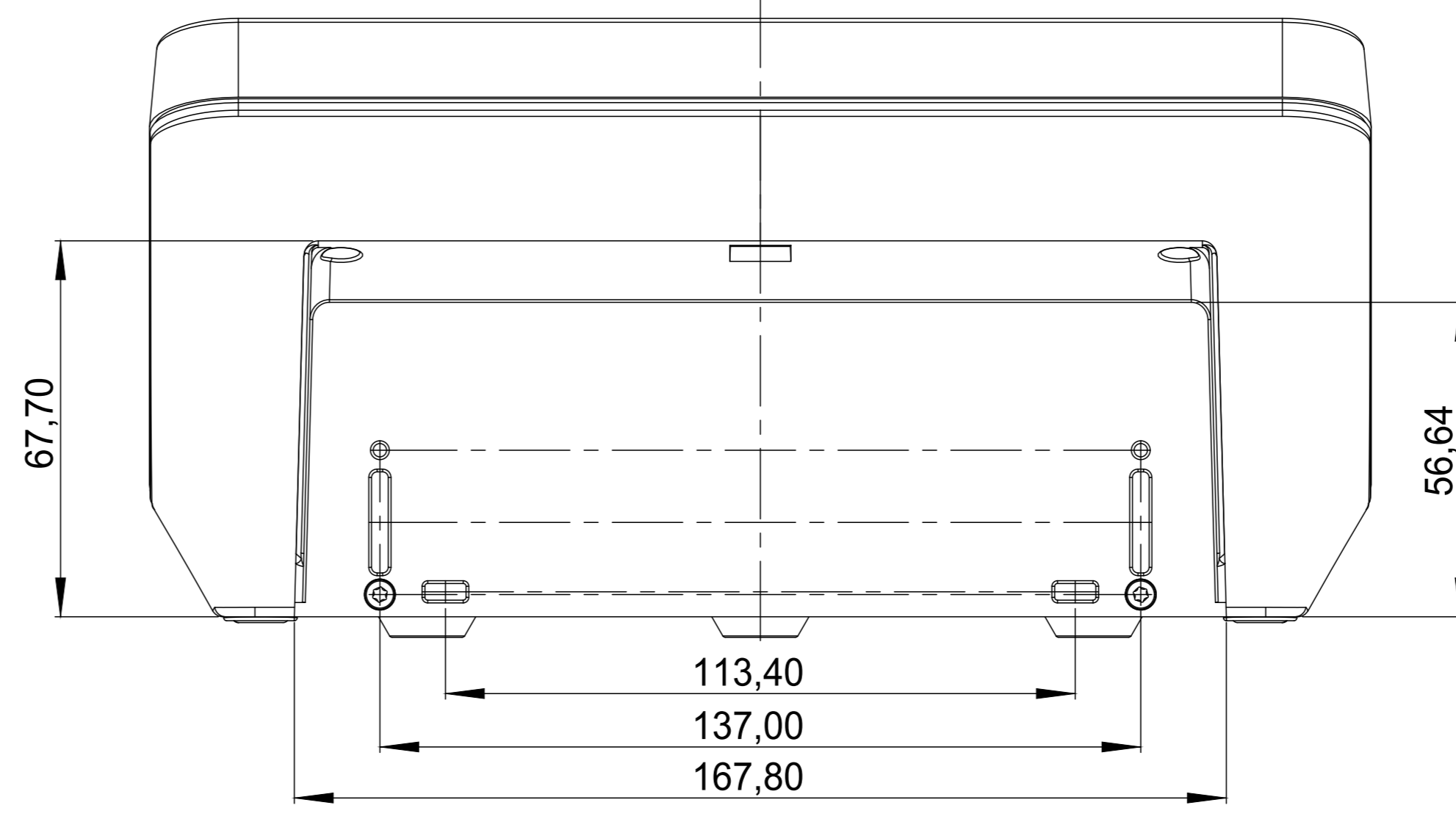

Platine Oberteil
P C B Top Part

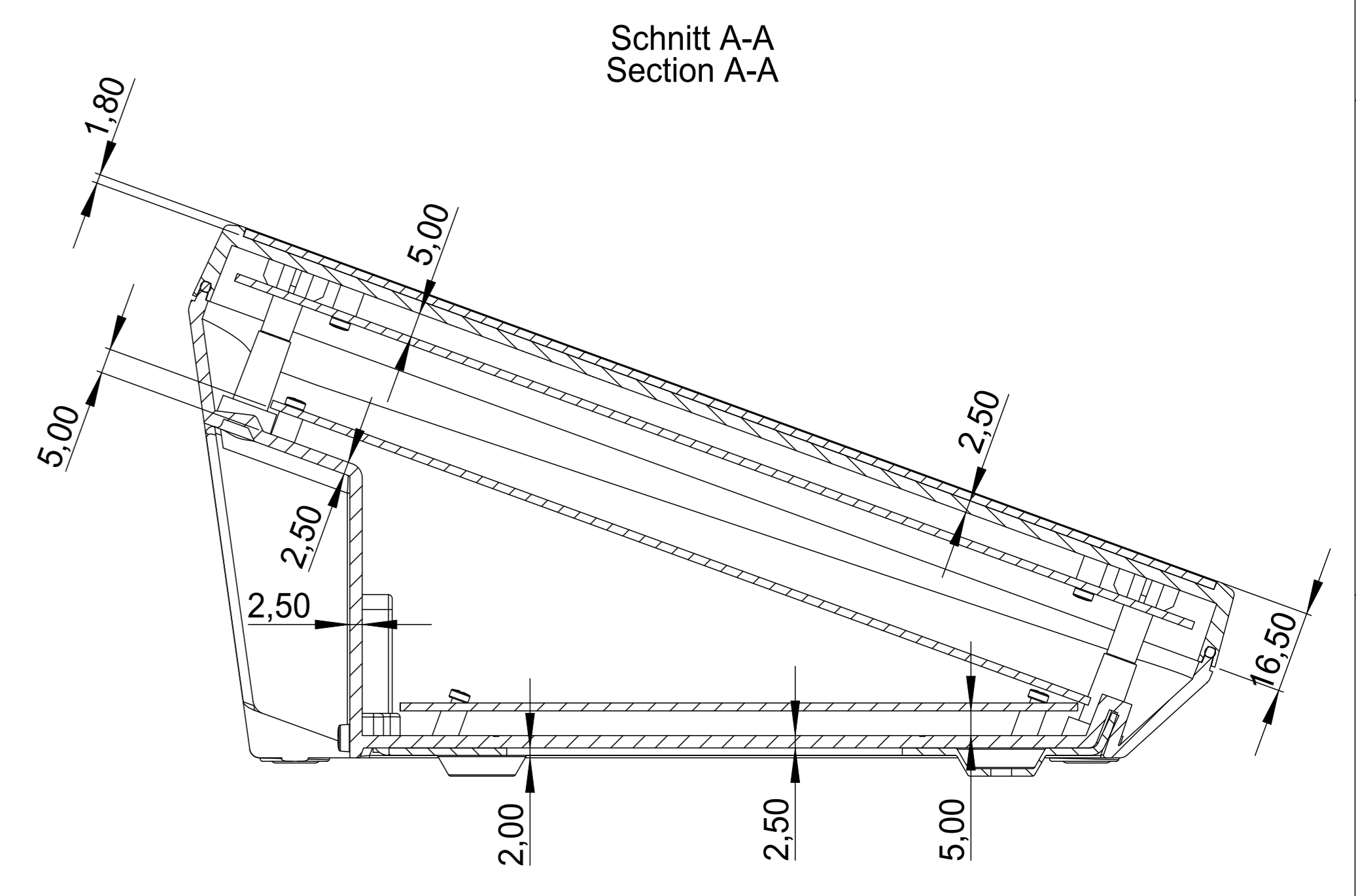

Schnitt A-A
Section A-A

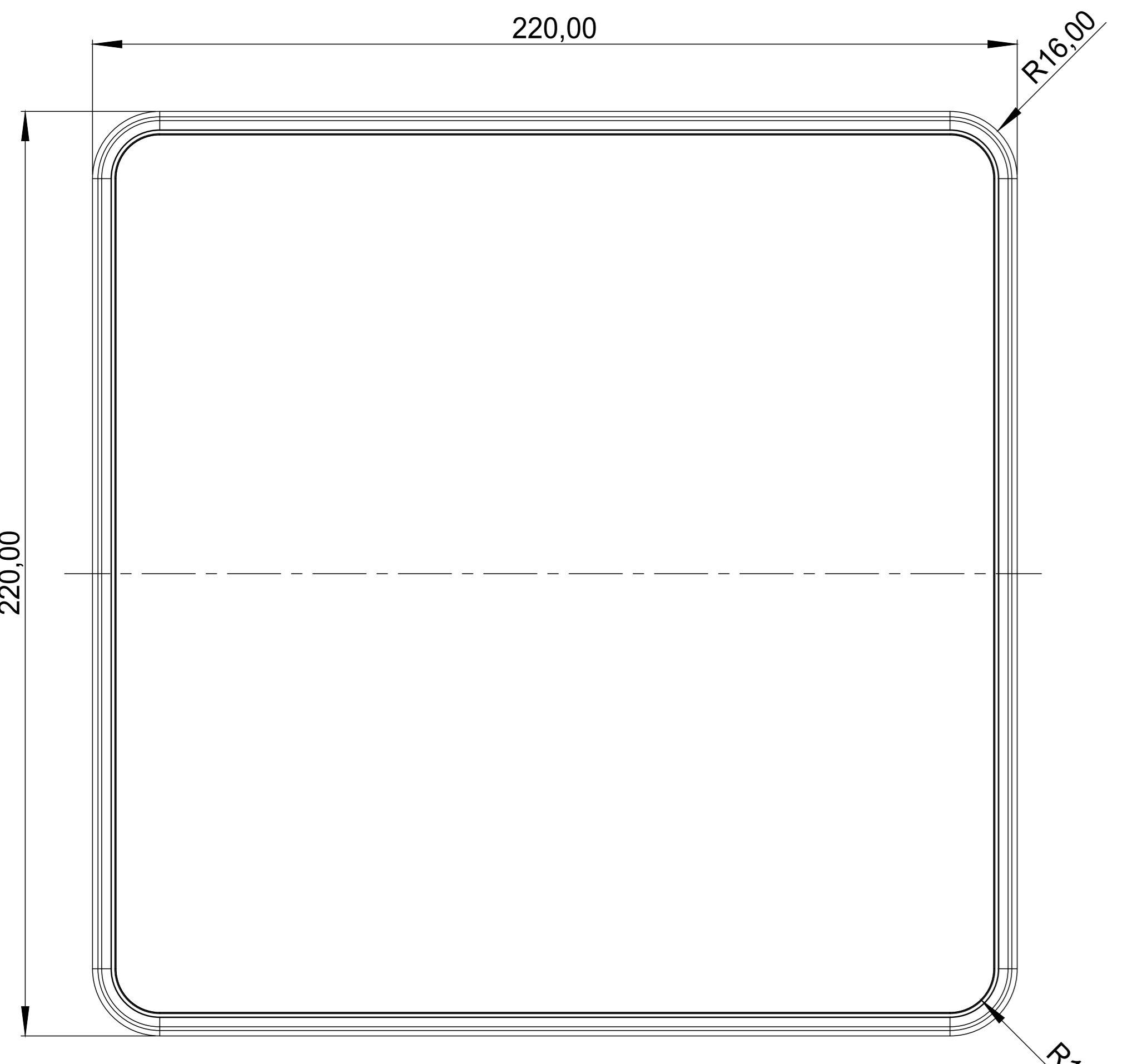

Oberteil
Top Part

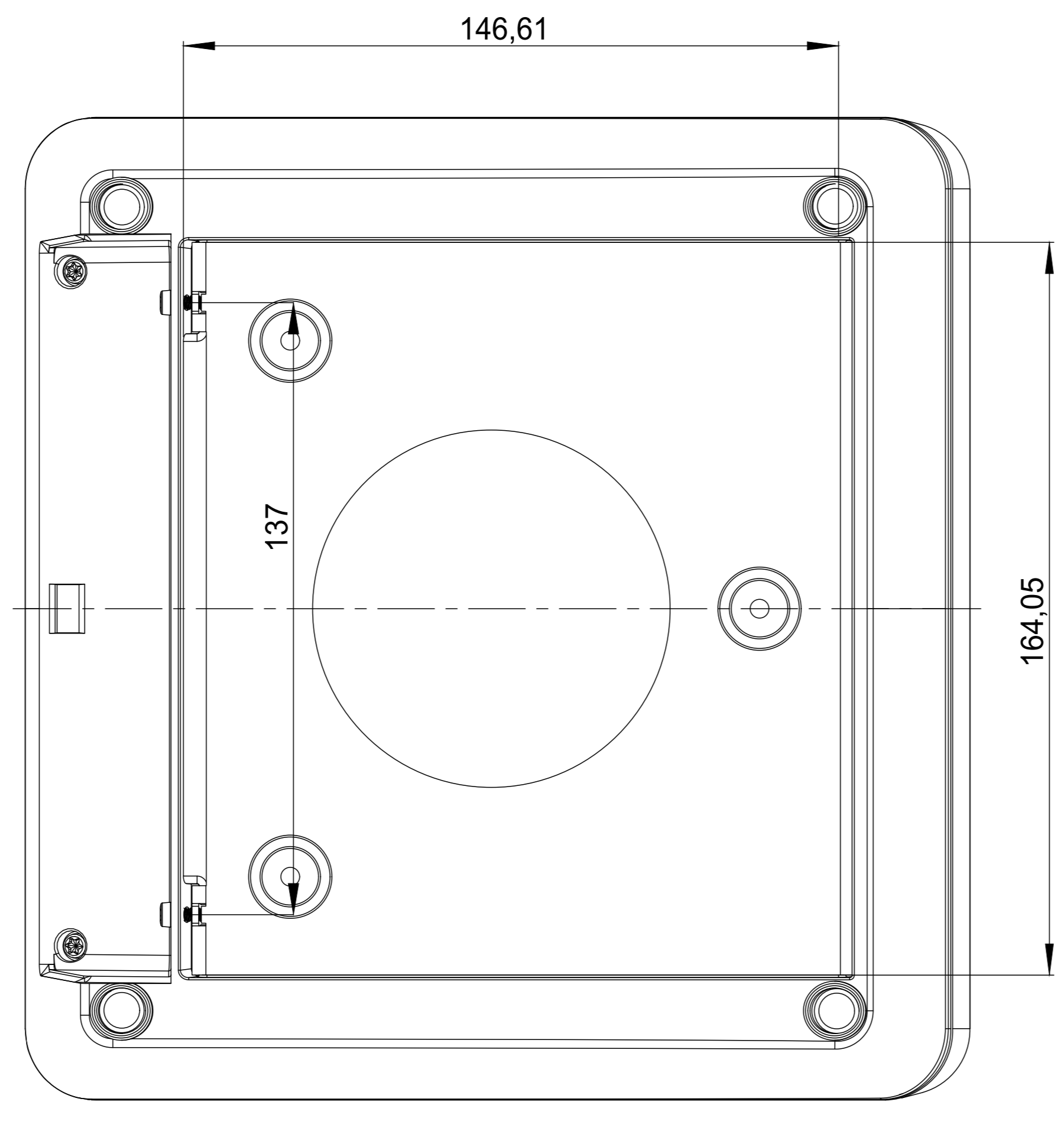

Unterteil
Bottom Part

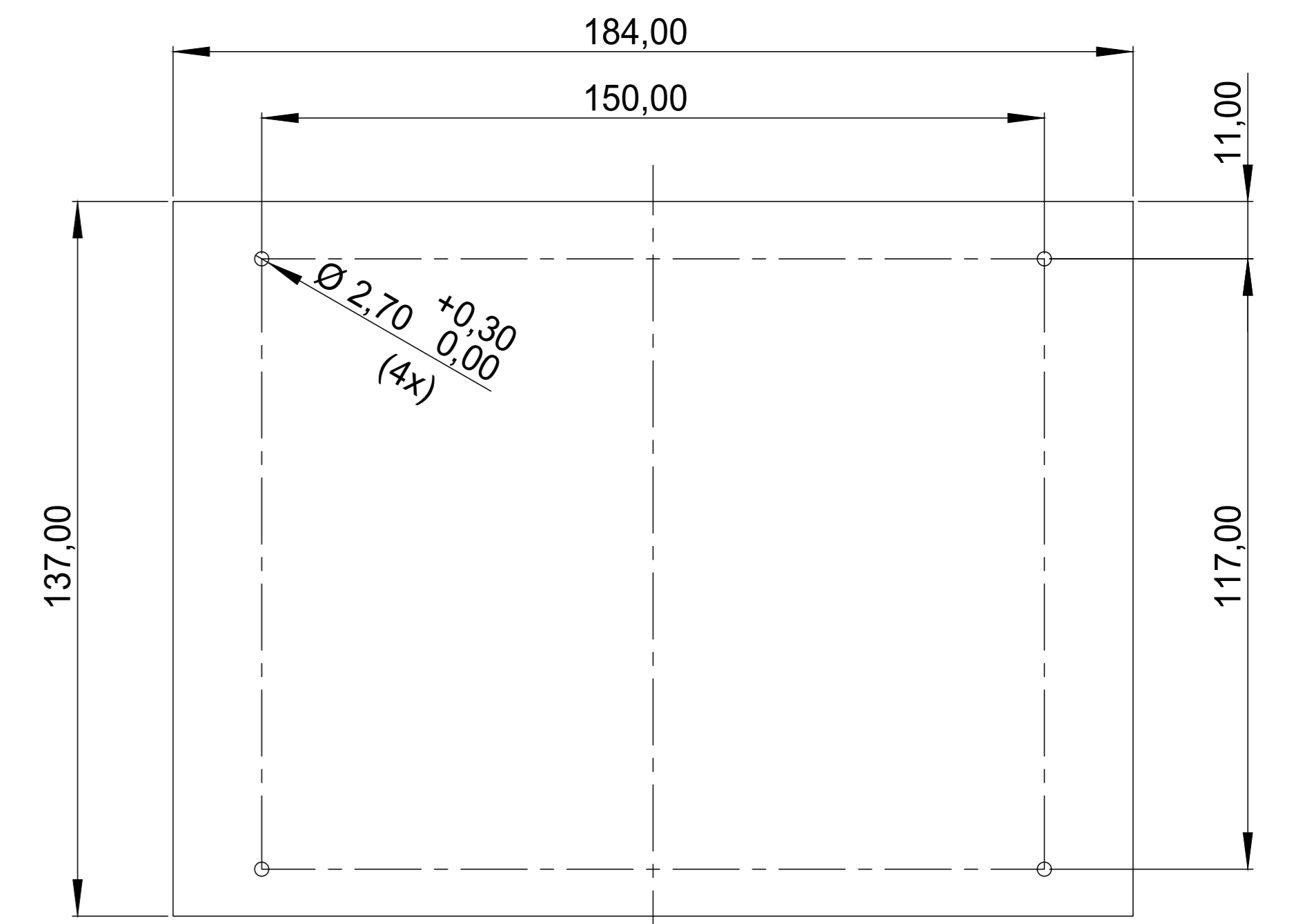
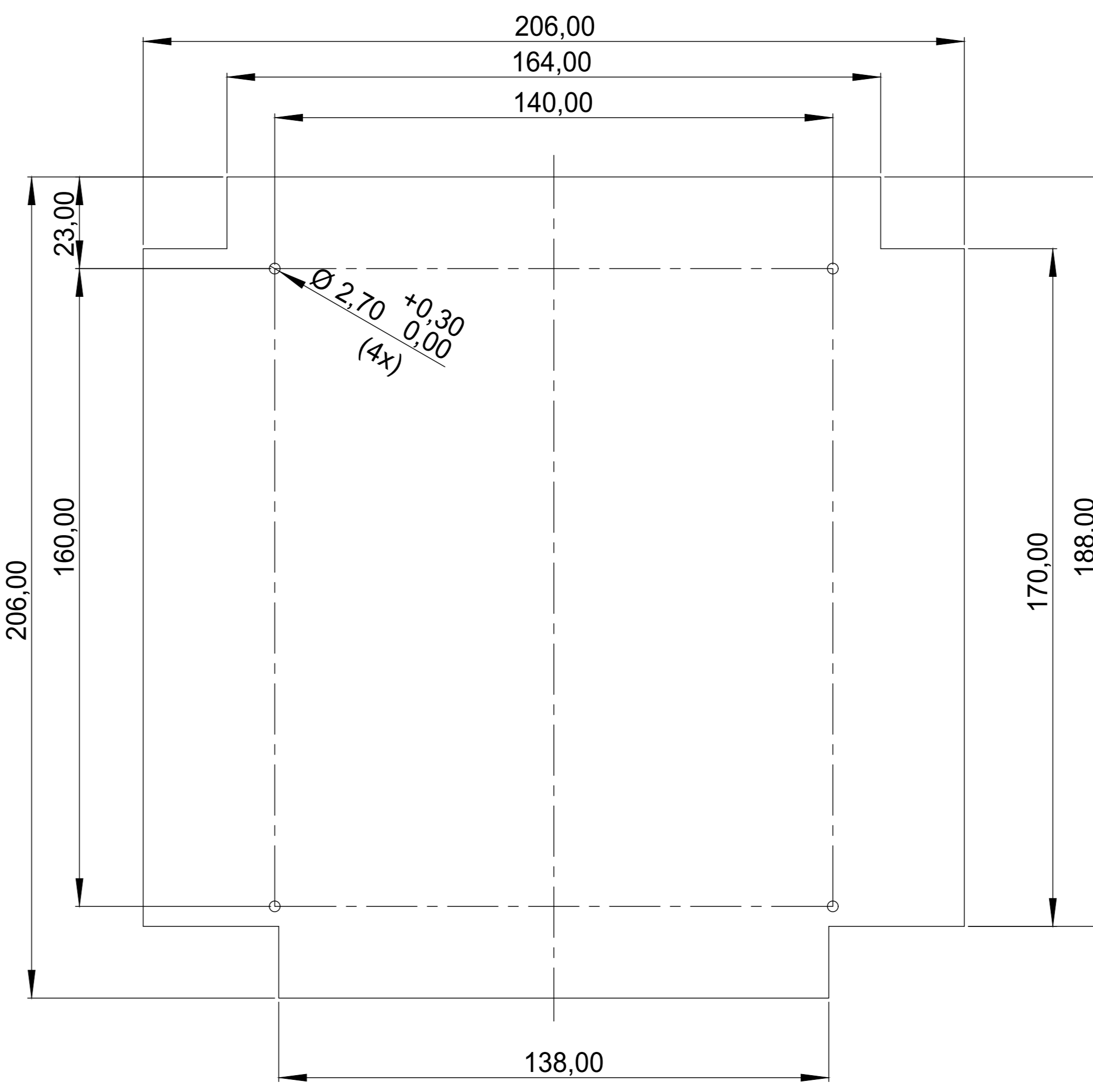

Platine Unterteil
P C B Bottom Part

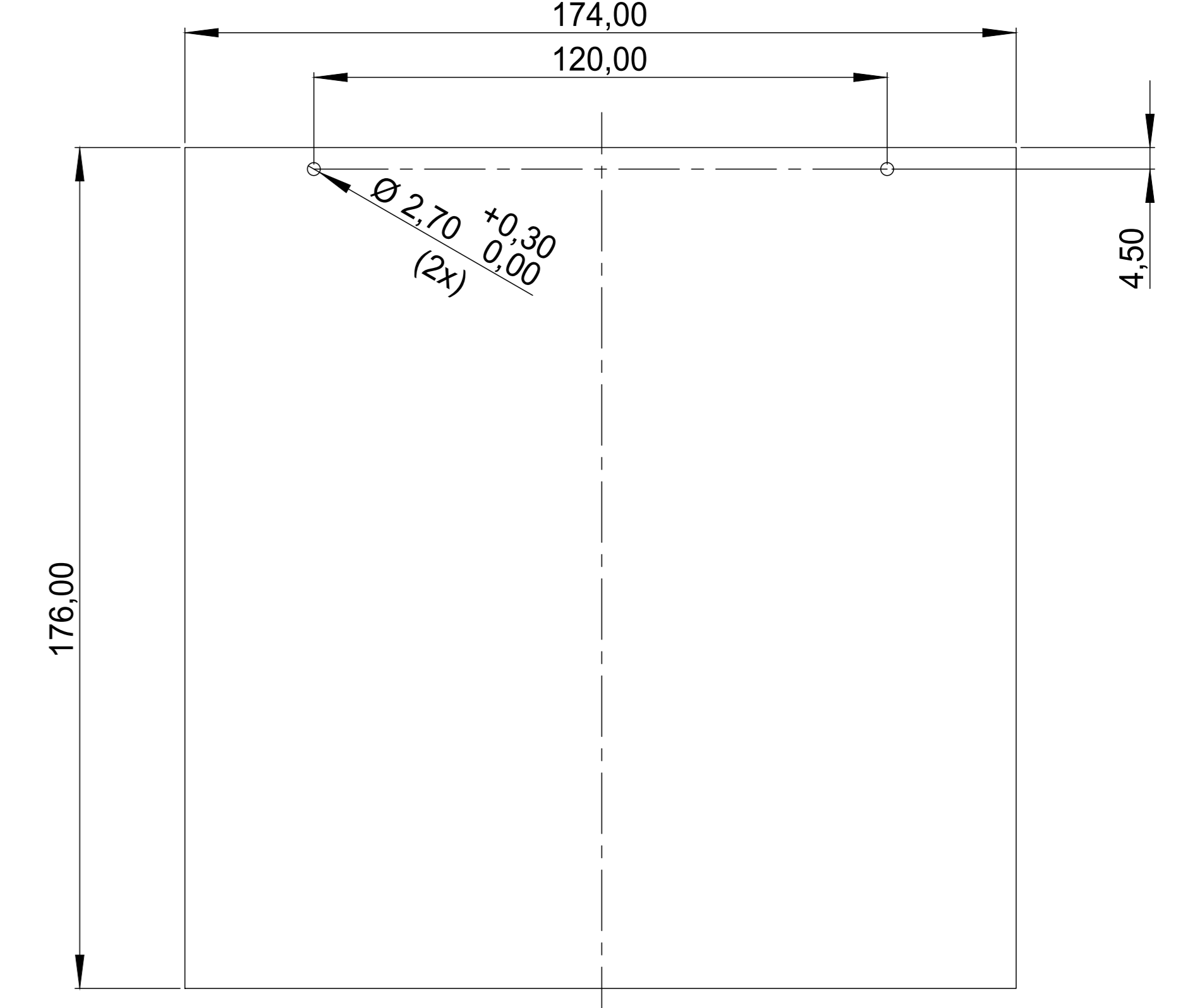
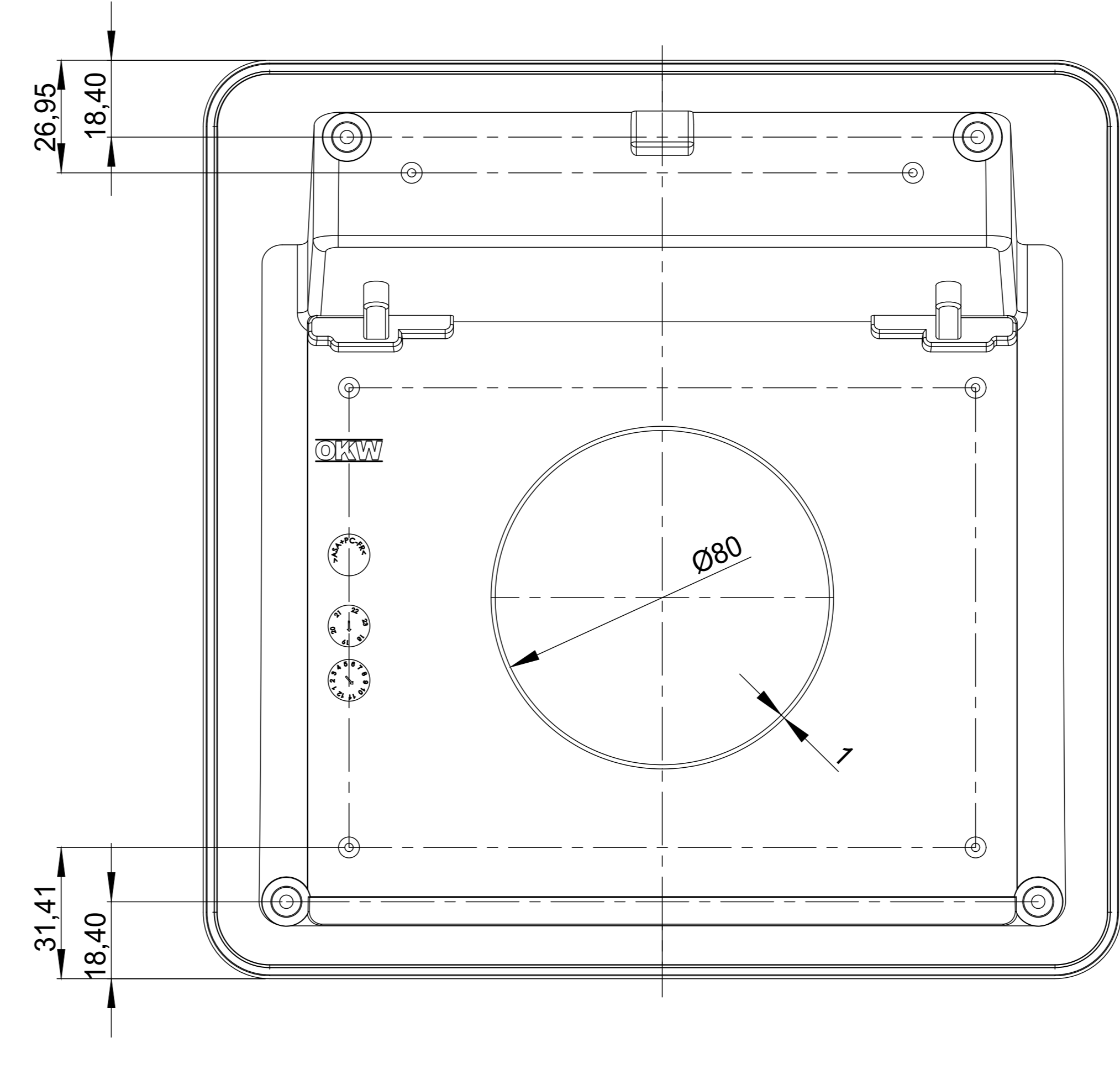
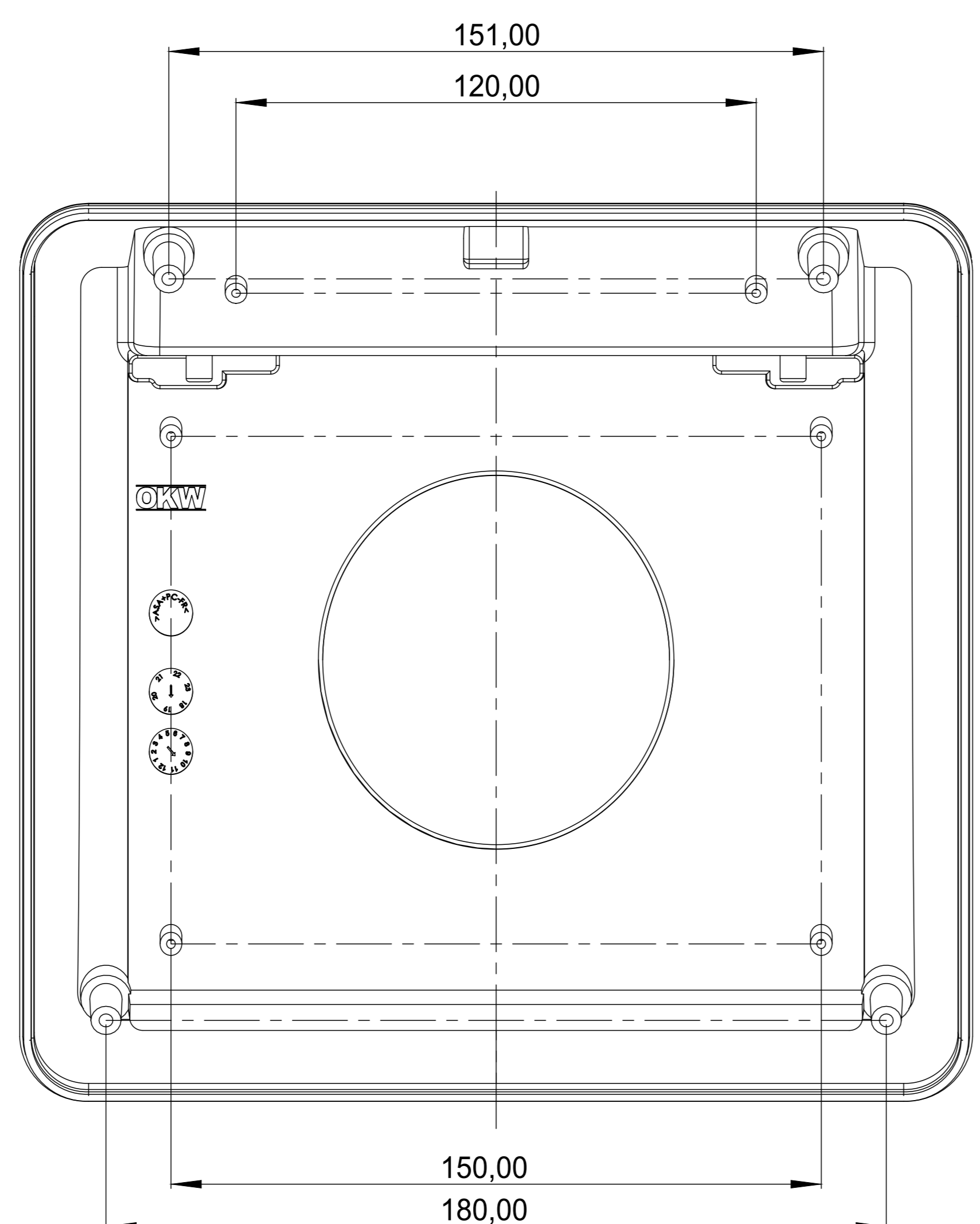
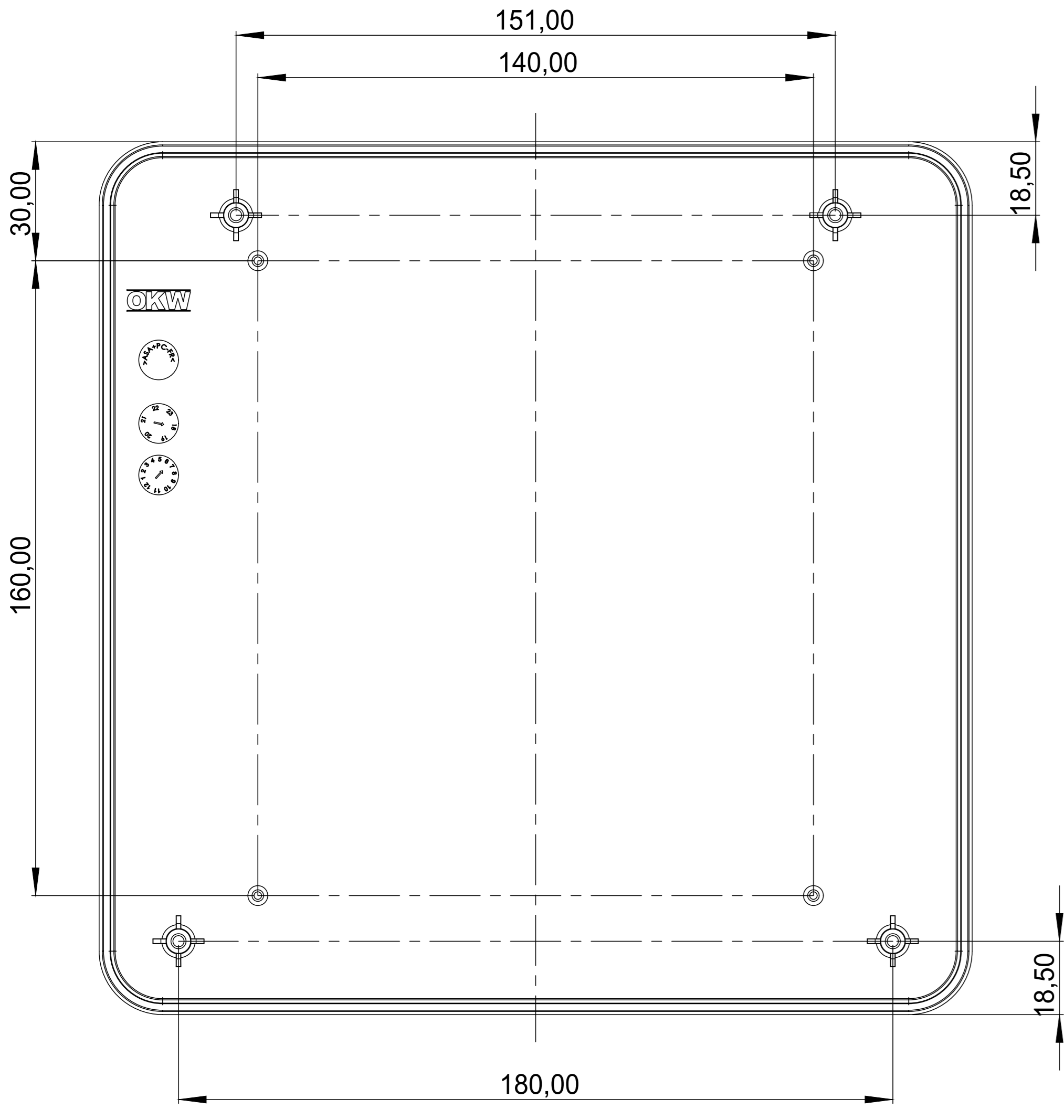

Folientastatur M 2:1
membrane keyboard

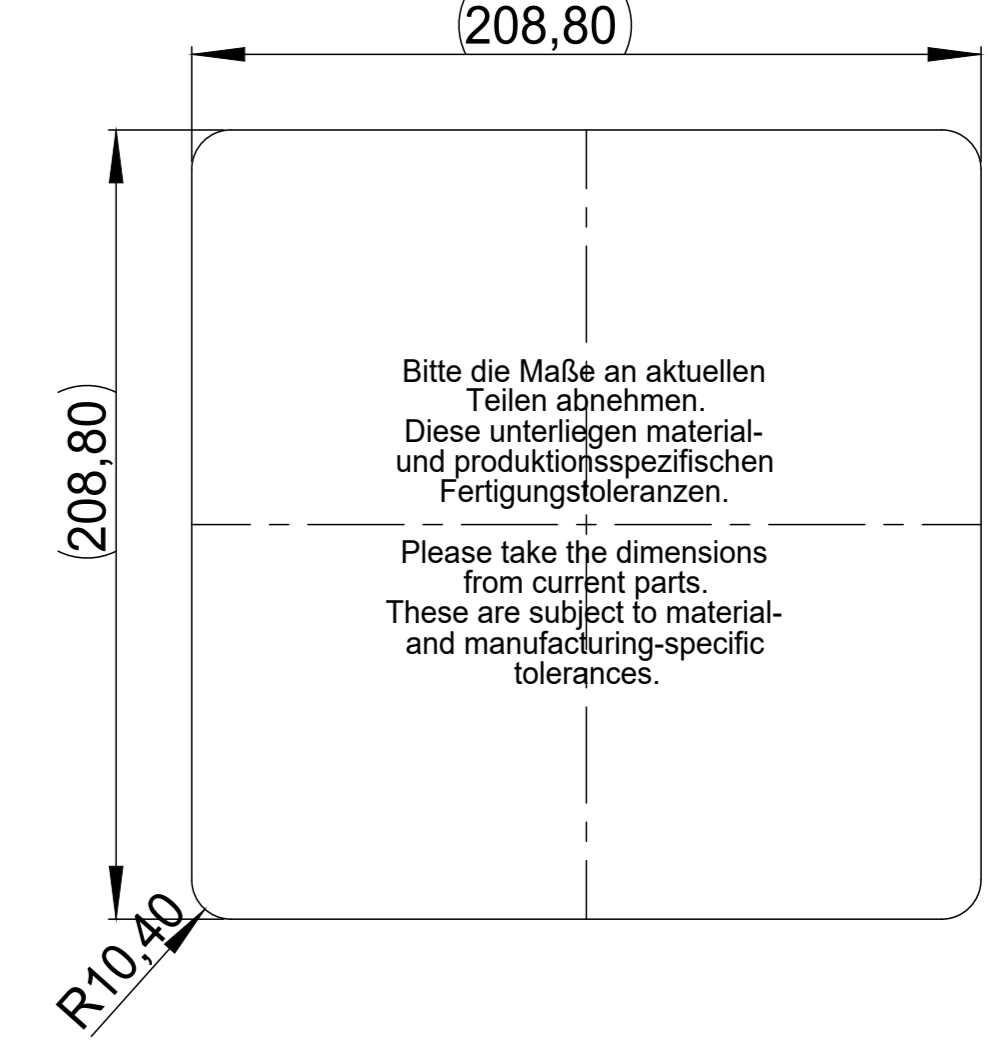

Bitte die Maße an aktuellen Teilen abnehmen. Diese unterliegen material- und produktionsspezifischen Fertigungstoleranzen.

Informationen
Copy for information

Entwurf: 12.07.2018
Gezeichnet: O. Hantsch
Prüfung: 28.11.2018
Revision: 02

Toleranzen:
DIN 18742 T0.5
Vervollnen:
KUNDE

Technische Änderungen vorbehalten. Für alle Änderungen vorarbeiten.
Bitte die Maße an aktuellen Teilen abnehmen. Diese unterliegen material- und produktionsspezifischen Fertigungstoleranzen.
Please take the dimensions from current parts. These are subject to material and manufacturing-specific tolerances.

OKW
GEHÄUSE SYSTEME

PROTEC 220
Gehäuse
B442210*

M 1:1